

Vertical EE bobbin drawing

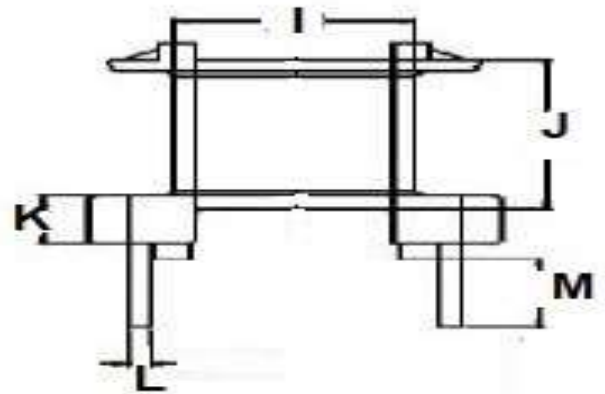

Product Specifications:

Geometry	Pin	A	B	C	D	E	F	G	H	I	J	K	L	M	N	O	P	Q
EE13/10V	5+5	8.90	3.80	16.00	10.30	4.85	10.80	7.80	2.10	11.20	9.15	2.10	0.60	4.50	12.70	16.10	12.60	2.50

Geometry: EE13/10 (V) 5+5 P	Material: Phenolic	Scale:	Angle: $\pm 1^\circ \blacktriangle$
	Pin Material: CP Wire	Unit: mm	Document Rev: 0
	Pin Pitch Tolerance: $\pm 0.20\text{mm}$	UL REQ: UL 94V-0	
	Dimensions Tolerances: 0~4mm: $\pm 0.1\text{mm}$, 4~16mm: $\pm 0.2\text{mm}$, 16~63mm: $\pm 0.3\text{mm}$		